

SPECIFICATIONS	
MOLDED BODY MATERIAL/COLOR	TPU/YELLOW
CONTACT CARRIER MATERIAL/COLOR	TPU/BLACK
CONTACT MATERIAL/PLATING	BRASS/GOLD
COUPLING NUT MATERIAL/PLATING	BRASS/NICKEL
RATED VOLTAGE [V]	300 V
RATED CURRENT [A]	9.0 A
TEMPERATURE RATING	-40°C to +80°C (-40°F to +176°F)
PROTECTION CLASS	MEETS NEMA 1,3,4,6P AND IEC IP67

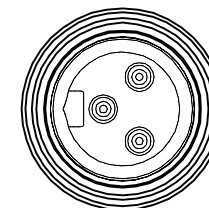
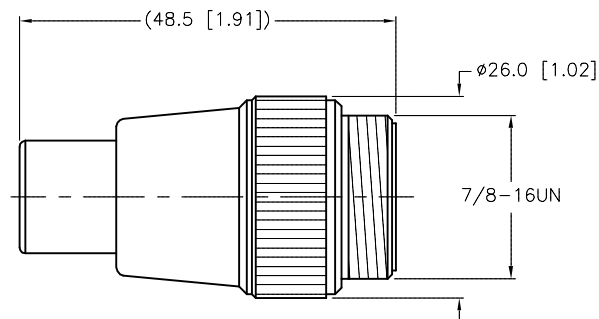

1. "/S771" DESIGNATES BLACK PLUG BODY.

# TURCK

RSM 30-J23/S771

REV  
B

DO NOT SCALE THIS DRAWING

SHEET 1 OF 1

NOTES:  1. "/S771" DESIGNATES BLACK PLUG BODY.					RELATED DOCUMENTS		3RD ANGLE PROJECTION		THIS DRAWING IS CONFIDENTIAL AND THE PROPERTY OF TURCK INC. USE OF THIS DOCUMENT WITHOUT WRITTEN PERMISSION IS PROHIBITED.		3000 CAMPUS DRIVE MINNEAPOLIS, MN 55441 1-800-544-7769 (763) 553-7300 (763) 553-0708 fax www.turck.us				
					1.										
					2.										
					3.										
4.		MATERIAL		ALL DIMENSIONS DISPLAYED ON THIS DRAWING ARE FOR REFERENCE ONLY		DRFT		RDS		DATE 02/21/08		DESCRIPTION  RSM 30-J23/S771			
						APVD				SCALE 1=1.0					
FINISH				CONTACT TURCK FOR MORE INFORMATION		UNIT OF MEASUREMENT  MILLIMETER [ INCH ]						IDENTIFICATION NO.  U0904-70		REV  B	
						DO NOT SCALE THIS DRAWING						FILE: U0904-70		SHEET 1 OF 1	
B	DRAWING PROCESSED AS PART OF ECO 33971			CBM	04/07/11	33971									
REV	DESCRIPTION			BY	DATE	ECO NO.									